

SNOHOMISH CASCADE
 PORTION OF THE NE 1/4 SE 1/4 OF SECTION 34, T28N, R5E, W.M.
 PORTION OF THE NW 1/4 SW 1/4 & SE 1/4 NW 1/4 OF SECTION 35, T28N, R5E, W.M.
 SNOHOMISH COUNTY
 DAVID EVANS & ASSOCIATES
 SEPTEMBER 1987
 BELLEVUE, WASHINGTON

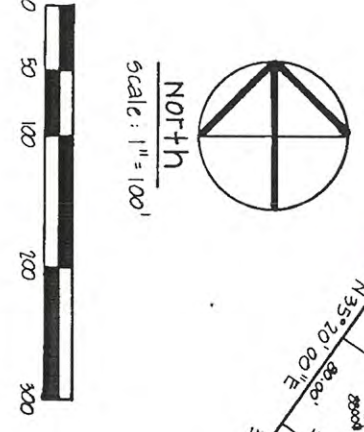

UNPLATTED
 SECTION 34 & 35, T28N, R5E, W.M.
 SNOHOMISH COUNTY, WASHINGTON
 DA 810225

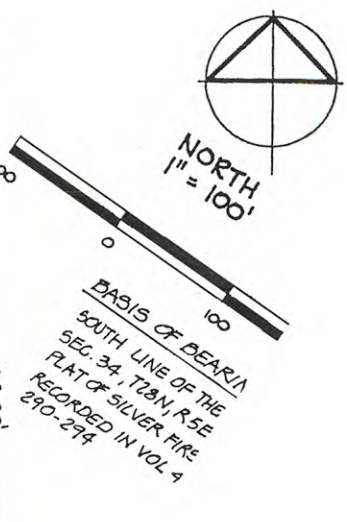

FOOTNOTES:
 1. ALL DIMENSIONS ARE IN FEET UNLESS OTHERWISE NOTED.
 2. SETBACKS ARE TO BE MEASURED FROM THE EXISTING GRADE UNLESS OTHERWISE NOTED.
 3. ALL DIMENSIONS ARE TO BE MEASURED FROM THE CENTERLINE OF THE LINE UNLESS OTHERWISE NOTED.

NOTES:
 1. THE SANITARY SEWER EASEMENT IS HEREBY EXCLUSIVELY RESERVED FOR AND GRANTED TO SILVER LAKE WATER DISTRICT (SLWD) FOR THE PURPOSE OF INSTITUTING MAINTENANCE AND OPERATING THE SANITARY SEWER SYSTEM.

RUSSET PARK, DN 3
 VOL 30 PGS 20-22

40' storm easement Rec. No. 87111001M
 N80°39'54"W 1928.64'
 N15°20'05"W 728.91'
 UNPLATTED